

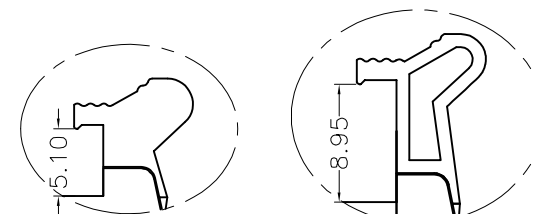

Recommended P.C.B Layout(Top Side)
(PCB BOARD TOLERANCE±0.05)

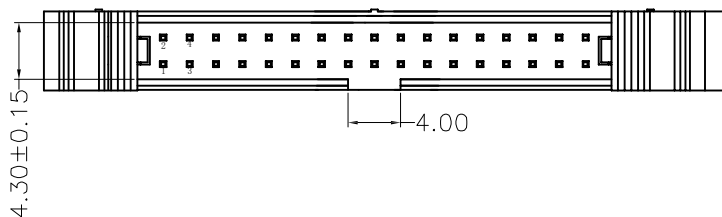
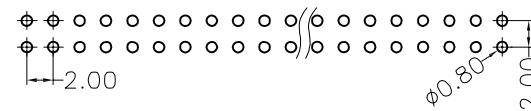

PART NUMBER CODING

EJES1- XX XX X X X X

- No. of Pins
08-68P
- Contact Plating
G0:Gold Flash
G1:3U"Gold
G2:5U"Gold
G3:10U"Gold
G4:15U"Gold
G5:20U"Gold
G6:30U"Gold
S0:Gold Flash/Tin
S1:3U"Gold/Tin
S2:5U"Gold/Tin
S3:10U"Gold/Tin
S4:15U"Gold/Tin
S5:20U"Gold/Tin
S6:30U"Gold/Tin
SN:Tin
- Latch type
L:Long Latch
S:Short Latch
- Color
B:Black
U:Blue
E:Gray(413C)
G:Gray(427C)
- Packing
A:Tray
T:Tube
- Insulator Material
1:PA6T
2:PA9T

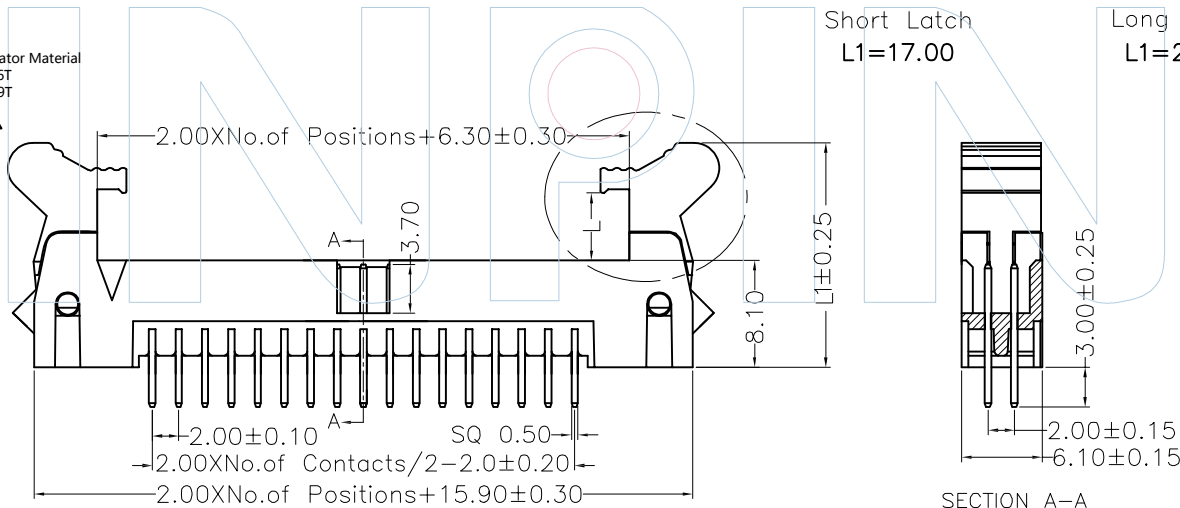

SECTION A-A



Tel:+86 769 82581808 FAX:+86 769 81766192
E-Mail:sales@winpin.net Http://www.winpin.net

PART NO: EJES1-XXXXXXX

TITLE: 2.00mm Ejector Header 180°

NOTES:
Current Rating:1.5AMP
Withstand Voltage:500V AC/DC
Contact Resistance:20mΩ Max
Insulation Resistance:1000MΩ Min
Operation Temperature:-40°C to +105°C

Contact Material:Brass
Contact Plating:Au or Sn over Ni
Insulator Material:PA6T or PA9T+30%G.F
(UL94V-0)

UNLESS OTHERWISE SPECIFIED DIMENSIONS ARE IN METRIC TOLERANCES ARE:

DECIMALS	Angle
X.X:±0.40	± 3°
X.XX:±0.25	
X.XXX:±0.15	
SCALE	1:1
UNIT	MM
PROJ.	
SHEET	

REV	DATE	MODIFICATION DESCRIPTION	DRAW	CHANGE	APPROVE
A1	2020/10/17	增加后缀2 PA9T料	Myron.Yuan		Myron.Yuan
A0	2015/06/25	NEW	Hua.ZT		Hua.ZT